

Front view and mounting

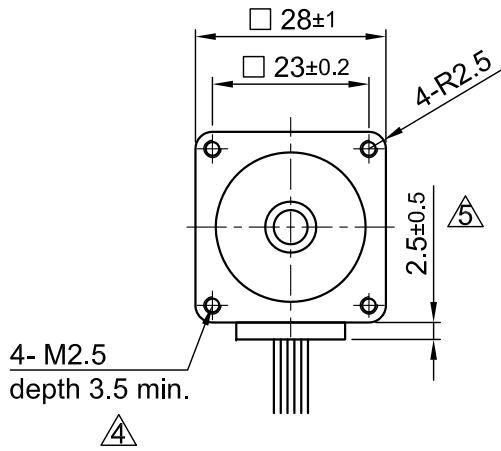

Side view

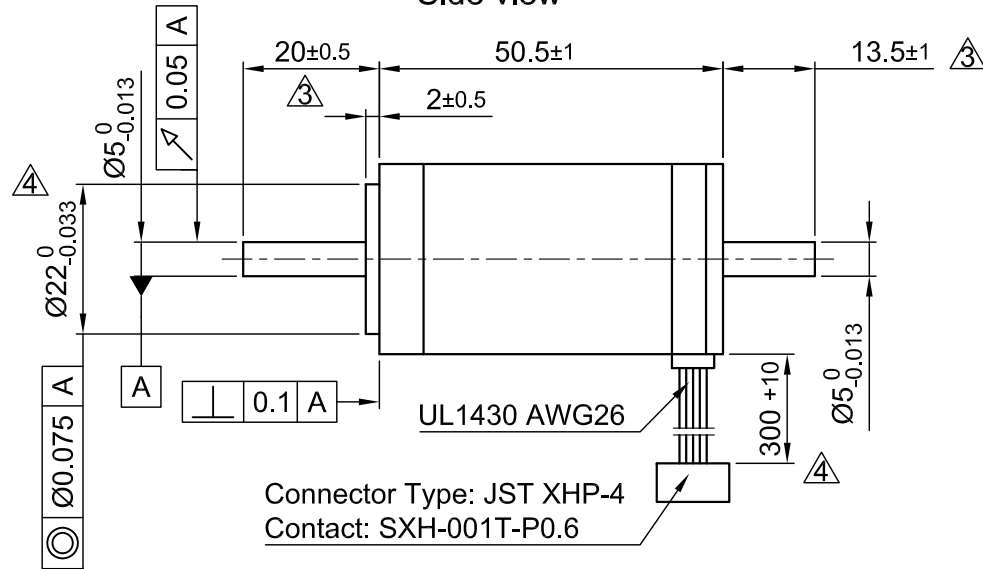

Rear view

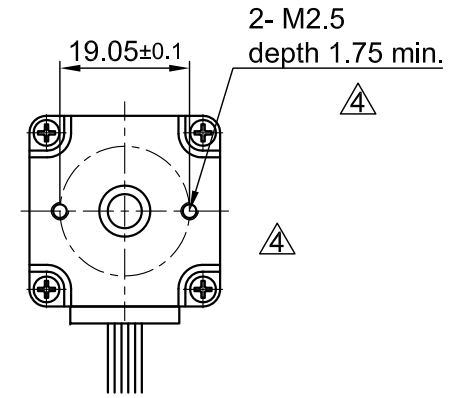

| SPECIFICATION | CONNECTION | BIPOLAR |
|--|------------|--|
| VOLTAGE (VDC) | | 3.22 |
| AMPS/PHASE | | 1.4 |
| RESISTANCE/PHASE (Ohms)@25°C | | 2.3±15% |
| INDUCTANCE/PHASE (mH) @1KHz | | 1.8±20% |
| HOLDING TORQUE (Nm) [lb-in] | | 0.117 [1.035] |
| DETENT TORQUE (Nm) [lb-in] | | 4.5x10 ⁻³ [0.04] |
| STEP ANGLE (°) | | 1.8 |
| STEP ACCURACY (NON-ACCUM) | | ±5% |
| ROTOR INERTIA (Kg-m ²) [lb-in ²] | | 1.8x10 ⁻⁶ [6.148x10 ⁻³] |
| WEIGHT (Kg) [lb] | | 0.25 [0.551] |
| TEMPERATURE RISE: MAX.80°C (MOTOR STANDSTILL; FOR 2 PHASE ENERGIZED) | | |
| AMBIENT TEMPERATURE -10~ 50°C [14°F ~ 122°F] | | |
| INSULATION RESISTANCE 100 MOhm (UNDER NORMAL TEMPERATURE AND HUMIDITY) | | |
| INSULATION CLASS B 130° [266°F] | | |
| DIELECTRIC STRENGTH 500VAC FOR 1 MIN. (BETWEEN THE MOTOR COILS AND THE MOTOR CASE) | | |
| AMBIENT HUMIDITY MAX. 85% (NO CONDENSATION) | | |

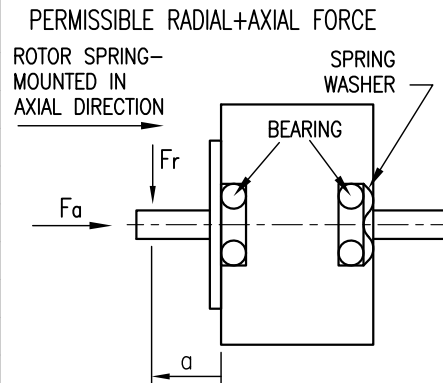

| AXIAL-FORCE Fa (N) | Fa=7 | | | |
|---------------------|-------|--------|----|----|
| DISTANCE a (mm) | 5 | 10 | 15 | 20 |
| RADIAL-FORCE Fr (N) | 58 | 36 | 26 | 20 |
| | AXIAL | RADIAL | | |
| SHAFT PLAY (mm) | 0.075 | 0.025 | | |
| AT LOAD MAX: (N) | 10 | 5.0 | | |

| TYPE OF CONNECTION (EXTERN) | MOTOR | | |
|-----------------------------|-------------------|-------|---------|
| | CONNECTOR PIN NO. | LEADS | WINDING |
| BIPOLAR | | | |
| A — | 1 | BK | A |
| A\ — | 2 | GN | A\ |
| B — | 3 | RD | B |
| B\ — | 4 | BU | B\ |

FULL STEP 2 PHASE-Ex., WHEN FACING MOUNTING END (X)

| STEP | A | B | A\ | B\ | |
|------|---|---|----|----|-----|
| 1 | + | + | - | - | CCW |
| 2 | - | + | + | - | |
| 3 | - | - | + | + | CW |
| 4 | + | - | - | + | |

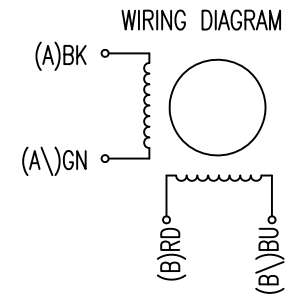

| REV | DESCRIPTION | DATE | DRN | Surface specification DIN ISO 1302 | | | General tolerances DIN ISO 2768- ch | | | Work piece edge DIN ISO 13715 | | | APVD | S.H. | 02.08.11 | STEPPING MOTOR |
|-----|-----------------------------------|----------|------|---------------------------------------|--|--|--|--|--|----------------------------------|--|--|-----------|------|----------|----------------|
| 5 | change tolerance/ revise drawing | 11.01.17 | A.S. | | | | | | | | | | CHKD | | | |
| 4 | CHANGE TOL. M2.5/Ø22/ rework draw | 17.12.15 | A.S. | | | | | | | | | | DRN | J.W. | 02.08.11 | DWG.NO |
| 3 | CHANGE TOLERANCE | 21.02.14 | J.D. | | | | | | | | | | SIGNATURE | | DATE | ST2818L1404-B |